

WWW.TVandNav2Go.Com

BMW New 3 5 6 Series (E60) RGB Interface
Installation/Connection Manual

NEW E60



This unit is designed to operate only **12 V DC, NEGATIVE ground** electrical system.

*** Parts ***

1) Interface



2) CVBS (IN/OUT) Cable

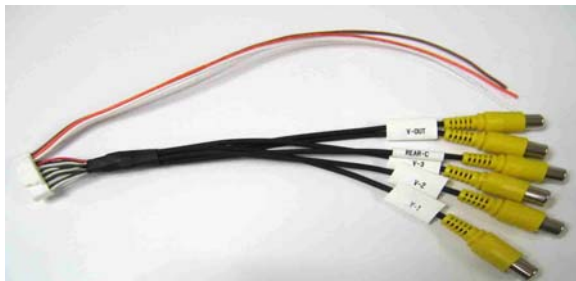

3) REMOTE CABLE (IR)



4) NAVI CABLE (7pin)

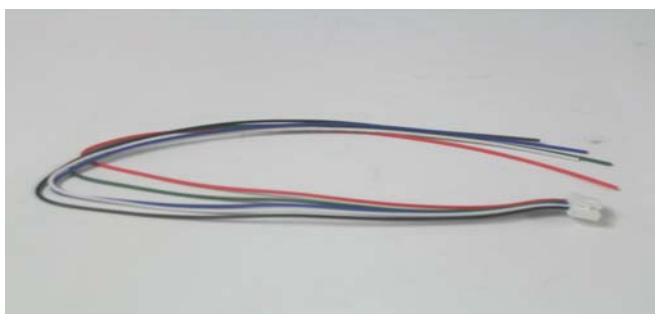

5) POWER Cable



6) LCD OUT Cable



*** The Picture of Completion ***

* Front



* Back



*** Installing ***

* IR Cable: It has receiving part from remote control



* Power Cable



- 1- Ground (black)
- 2- Source (orange)
- 3- Safe (green)
- 4- N.C.
- 5- ACC (red)
- 6- R/V (grey)

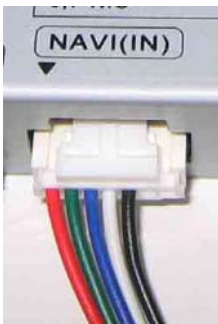

* NAVI - IN Cable

- 1 - R (red)
- 2 - G (green)
- 3 - B (blue)
- 4 - Sync (white)
- 5 - GND (black)
- 6, 7- N.C.

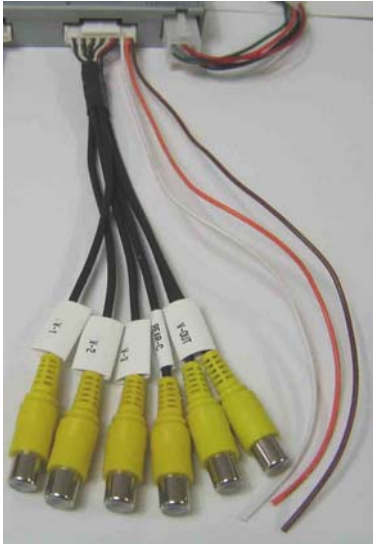

*CVBS (IN/OUT) Cable

- Input -

V-1: Video 1

V-2: Video 2

V-3: Video 3

Rear-C: Rear Camera

- Output -

V-Out: to the Monitor

White: Audio 1 (12V)

Orange: Audio 2 (12V)

Brown: Audio 3 (12V)



LCD-OUT : video source out to monitor(connect our supply part)

LCD- IN : connect OEM cable From Car System

Option S/W (DIP Switch)

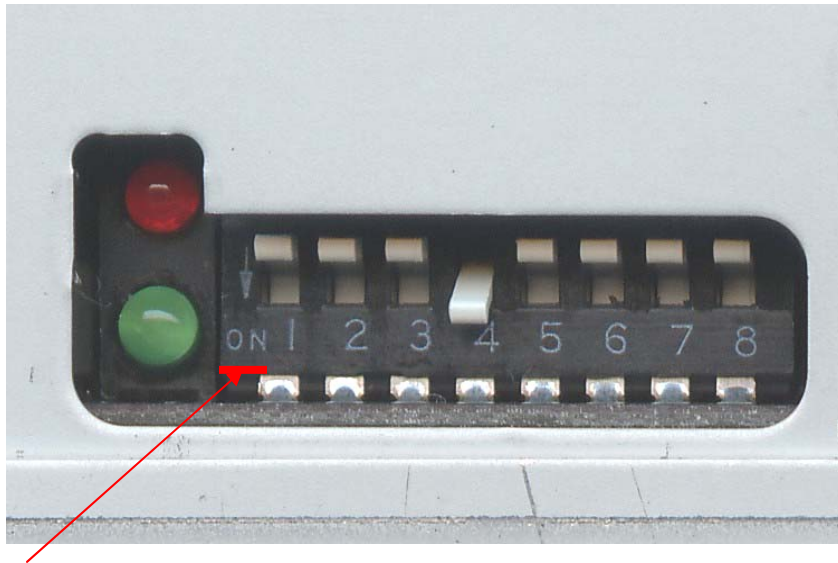

It was miss printed, I make sure that down direction mean that switches off.

* PIN 1 ~ PIN 4

- PIN 1 : Navi(RGB)
- PIN 2 : CVBS1
- PIN 3 : CVBS2
- PIN 4 : CVBS3

* PIN 5 ~ PIN 6

- PIN 5 : This switch can control(Size) between 6.5" & 8.8"
 - 6.5" : switched **Off(Down)**
 - 8.8" : switched **On(Up)**
- PIN 6 : It is can control between Alpine & Siemens.
 - Siemens : **Off(Down)**
 - Alpine : **On(up)**

This function is only works with 6.5" Monitor.

* PIN 7 : Rear Camera Control

- If you use Back Up Cam : switched **On(up)**
- If you do not use : switched **Off(Down)**

* PIN 8 : NO USE

Caution: When you setting the DIP switch, you must turned off the ignition!!

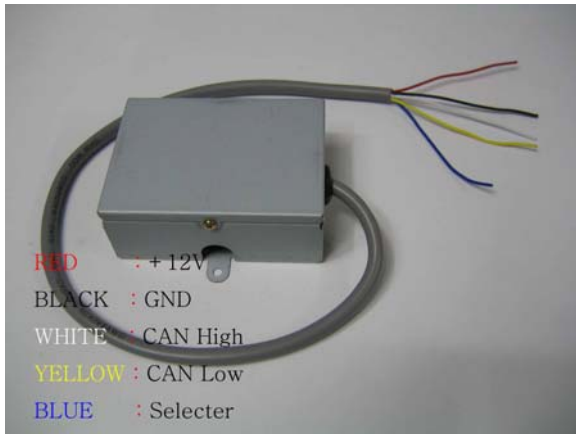

RED: + 12V
BLACK : GND
WHITE : CAN HIGH
YELLOW: CAN LOW
BLUE : SELECTE SIGNAL
joined to Orange of the power cable

You can find it our which is 12 pin Connector behind of Monitor.

Among 12 wires the Black wire is Can High

Yellow wire is Can Low

Do not cut the Can High & Low wire; you must be joining those wires.

**** Safety Advices Before Installation**

Caution:

Installation requires special knowledge and should be done by trained personnel.

Please read these instructions carefully before you start your work!

Even twice ore more times, if needed.

Please work with caution and patience.

Use suitable and recommended tools only and handle all parts with special attention.

Follow to the regulations concerning the vehicle's electric system.

Remove the ignition key before you start the installation!

Take care that no electric consumers are still switched on!

The car's electric system must be in a state of quiescent current!

Installation may only be done during idle status.

Thereby please pay attention to the car's manufacturer requirements.

This interface is to be used in cars with 12V negative ground only!

2) E60 Removal of The Front – Monitor



A) Remove the two screws at the monitors top which fix it to the dashboard.

Use a torx screwdriver and work carefully. The screws are marked on the picture for better orientation.



B) At the upper junction between the monitor and the dashboard where you've just removed the screws you can see a small gap.

Move a small screwdriver into that junction at any place carefully the display will drop to you out of its mounting.

C) Take the monitor carefully and turn its backside to you.

Be careful with the harnesses and connectors.

3) E60 Connecting The Interface

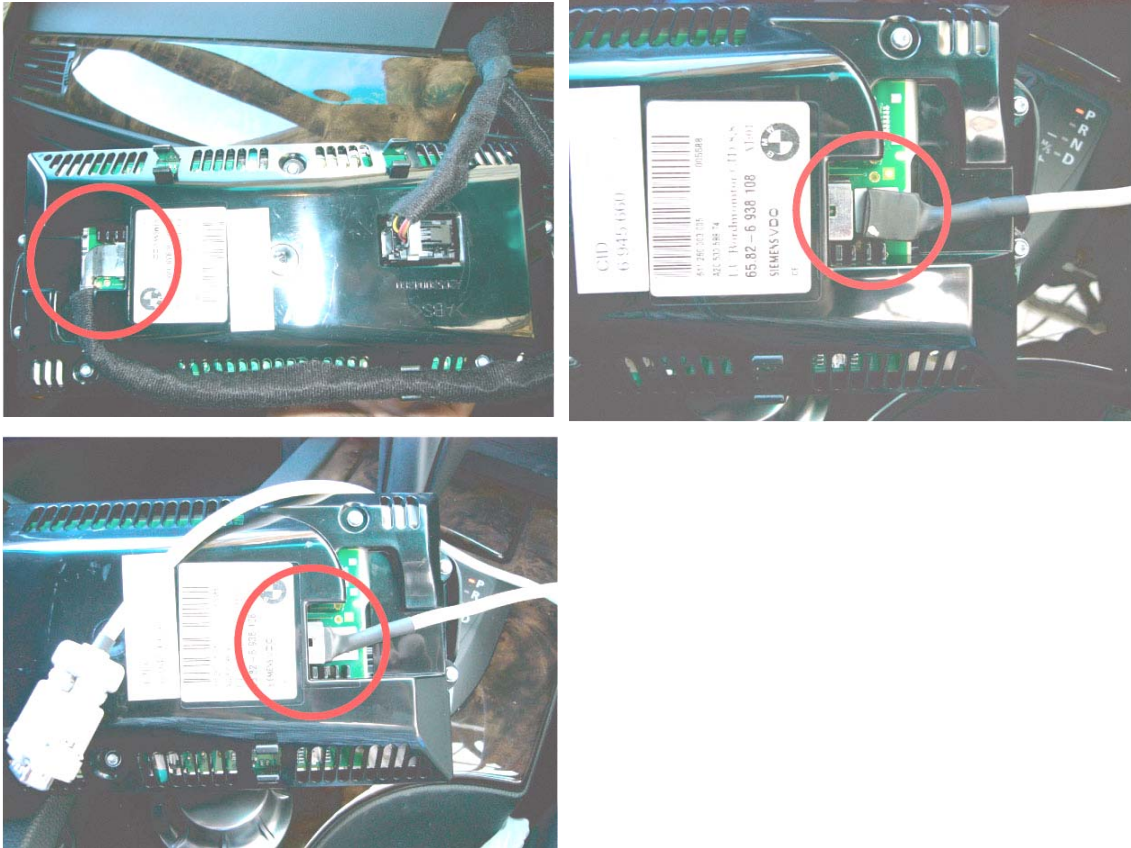

D) Connect LVDS OUT cable(supply part) at the LVDS OUT socket of the Interface and monitor's right backside.

There's a white marked spot at the plugs head to show in which way must be connected. This spot **MUST** be directed in such way that you can see it when connecting the plug to the metal socket. And therefore it must point away from the monitor!

E) Connect the other OEM plug to the LVDS IN port at the interface.

F) Make sure all connections are made correctly the right way as described!

CAUTION: The white marked spot at the plugs head **MUST** be at the same side of the video connector which did point away from the monitor to you when it was installed before disconnecting.

You may use the pictures for orientation. The Plug was marked with "TOP"-this is now the side with the white spot.

Wrong installation may cause serious conflicts with the cars electric systems!

CAUTION: When you update the car computing system, it must be cut off which is connected to Acc power.

WWW.TVandNav2Go.Com
718-763-7367

7718 Flatlands Ave Brooklyn, New York 11236
sales@tvandnav2go.com