

INSTALL GUIDE

ice>Link Gateway 500 MOST



V2.01

State of the art car integration for media players, USB and Bluetooth devices

DEGW5-9210-2



Gateway 500 MOST Install Guide

The Ice >Link Gateway 500 transfers the iPod, USB mass storage devices or any AUX audio signal to your car's audio system.

The package contains the following kits:

ice >Link Gateway devices

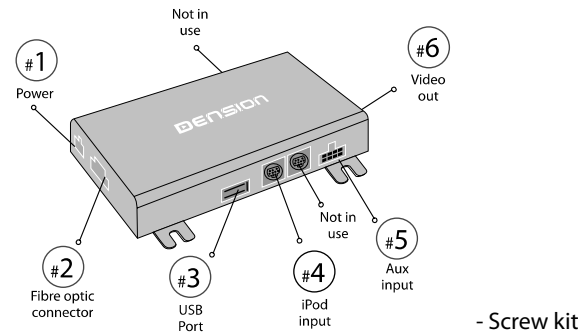

#1 Power harness

- Black wire: ground
- red wire: +12V power (non switched)

#2 MOST optical connection kit



2/1., Male/male inline connector (1 pcs)

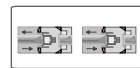

2/2., Plastic fibreinline optic housings (2pcs)



2/6., Plastic fibre optic housing (1 pcs)

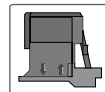

2/3., Tyco male connector (2pcs)

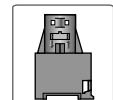

2/4., Tyco female connector (1 pcs)

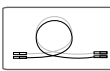

2/5., Fibre optic length=1m (2pcs)

#3 USB extension cable kit



- USB extension cable

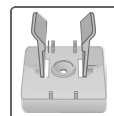

- Clip



- Grommet

- Screw kit

1

#4 iPod dock cable kit

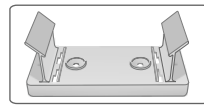

- iPod video clip

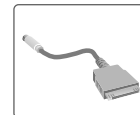

- iPod dock cable

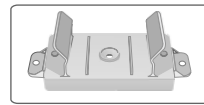

- iPod nano clip

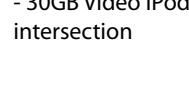

- Screw kit

- 30GB Video iPod intersection

#5 Aux box kit

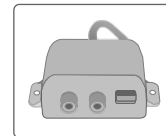

- AUX box

- Screw kit

See Dension Accessories at:
www.dension.com/accessories

Introduction

In order to use your Gateway 500 product you have to install it into the MOST (Media Oriented Systems Transport) optical ring of the car.

The MOST ring can contain various optical devices. Gateway 500 simulates a CD Changer so it will replace the functions of the original CD Changer.

Car type	Possible CD Changer retention
Audi MMI high A6/S6/A8/S8	✓
Audi MMI high Q7	✓
Audi MMI basic	-
BMW	✓
Mercedes	✓
Porsche CDR	-
Porsche PCM	-
Saab front CDP/CDC & rear CDC	-
Saab front CDP/CDC	✓

2

Preparation

Make sure that the Most ring of the car can accept CD Changer or obviously a CD Changer exists in the car.



CD Changer is the a main condition of the usage of Gateway 500. So if a CD Changer does not exist in the audio system, the CD Changer interface might need to be enable on the head unit might require a service where re-configuration will result.

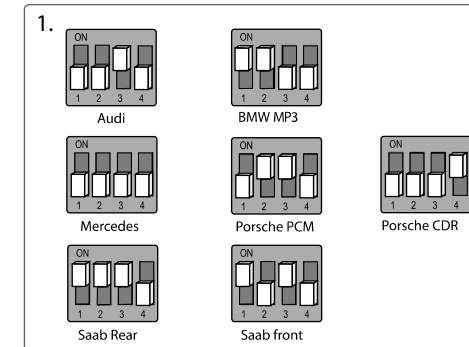

The best place to install the ice>Link Gateway 500 may be somewhere behind the dashboard/head unit or behind the glove compartment/CD Changer.

Installation steps



Note: the optical cables need to be handled with care. Keep the cable free from dirt, grime and sharp edges. do not expose it to excessive temperatures. Do not bend the optical cables in a radius smaller than 25 mm.

Break the optical ring at one of your optical device. For this, disconnect the plastic fibre optic housing from the back of the device. Figure #1. Dismount of the optical fibres.

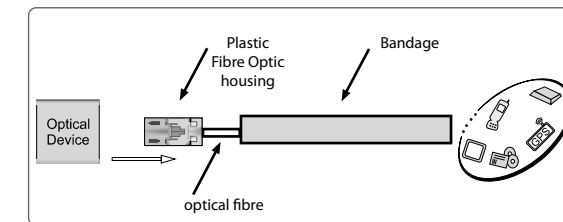

Remove one of the optical fibres from the housing. To decide witch fibre should be removed, please take care of the layout of the Gateway 500 in the MOST network, refer to Figure #1. Also **consider the light directions (arrows on the connector housing will help to you).**

3

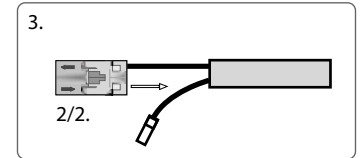
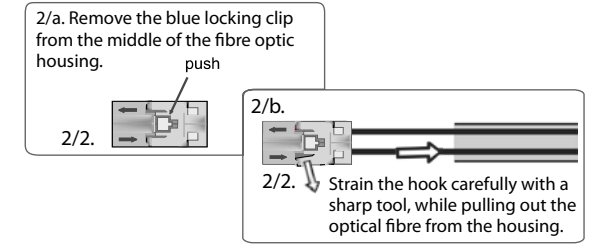

Assemble of the optical parts

1. Remove the blue locking clip from the middle of the fibre optic housing.

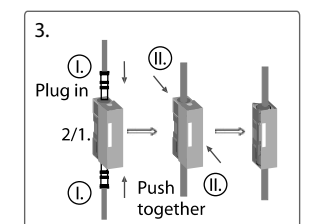
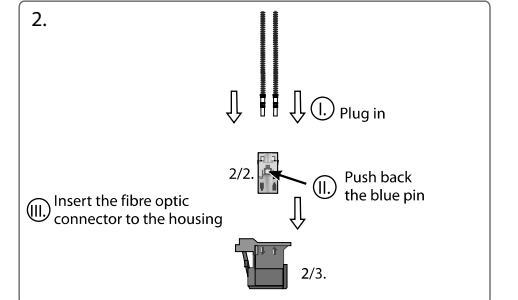
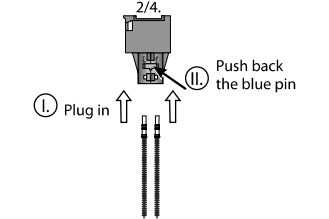

4

CDC
Audi A6 MMI Monochrome,
Porsche (911,997, Boxter, Cayman)

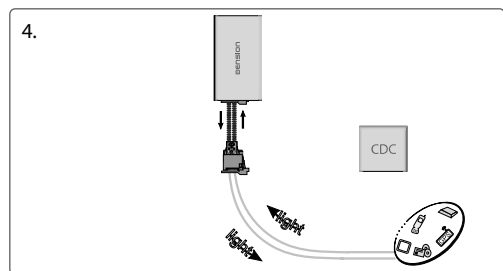
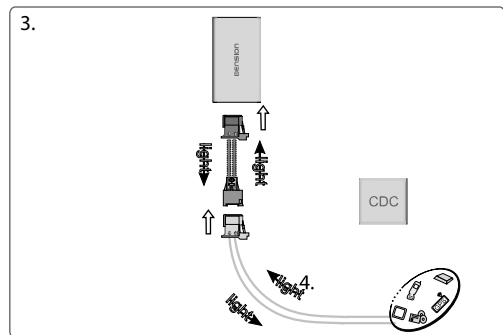
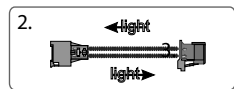
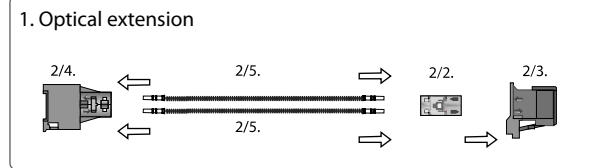

Mercedes, Saab, BMW without CDC

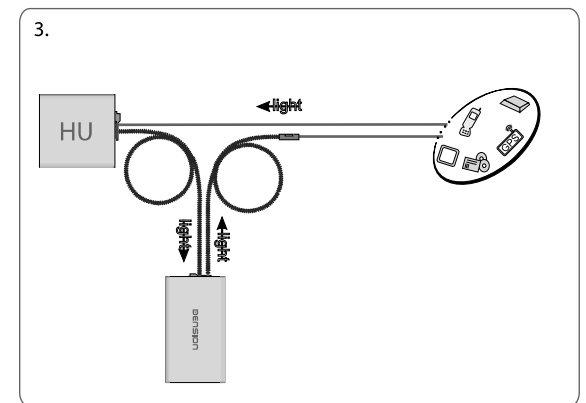
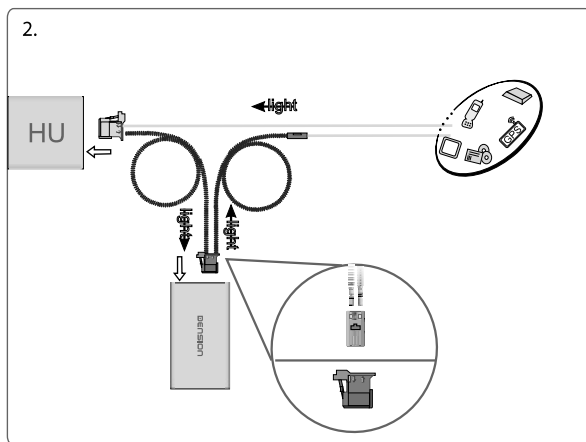
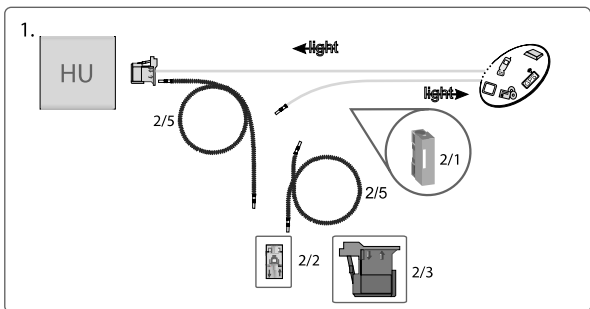

Check again that the leads in all connection are not confused with one another.

Audi A6, A8, BMW E87, E90, E91, E65, E66, Mercedes with CDC

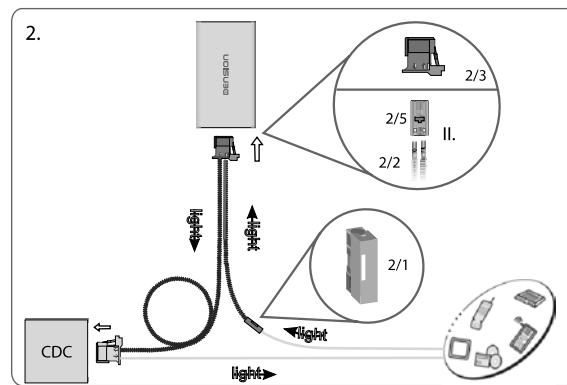
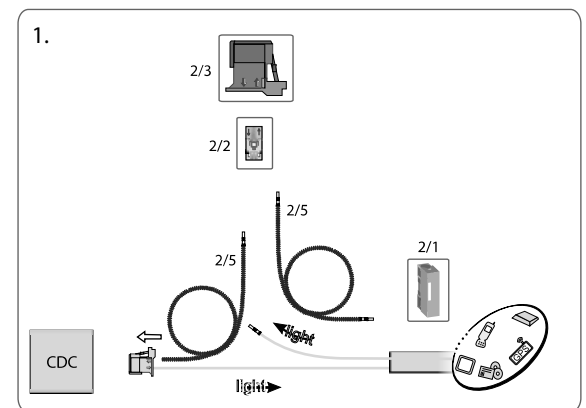

Check again that the leads in all connection are not confused with one another.

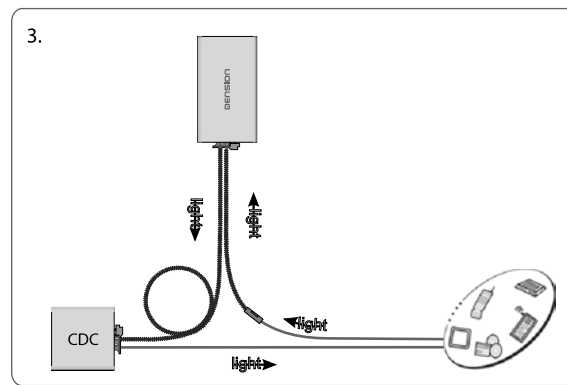

Only head unit exits (e.g. Porsche, Mercedes)

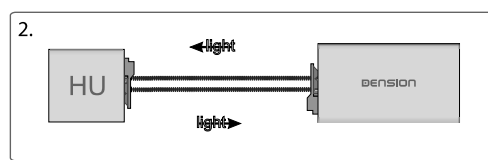
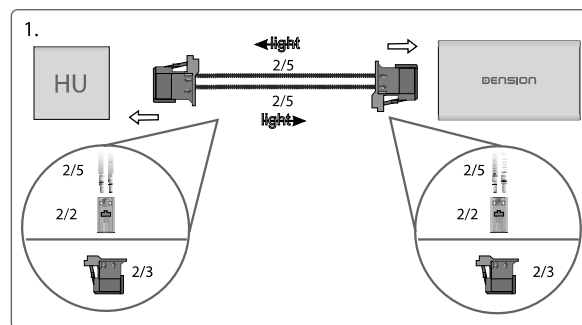

BMW E60/E61 with CDC

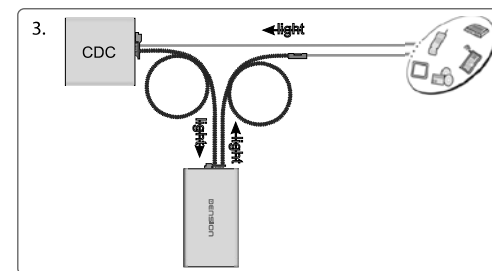
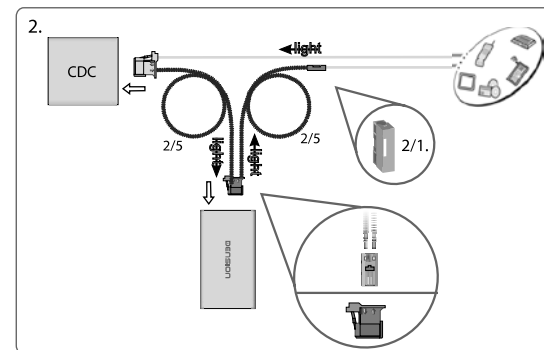
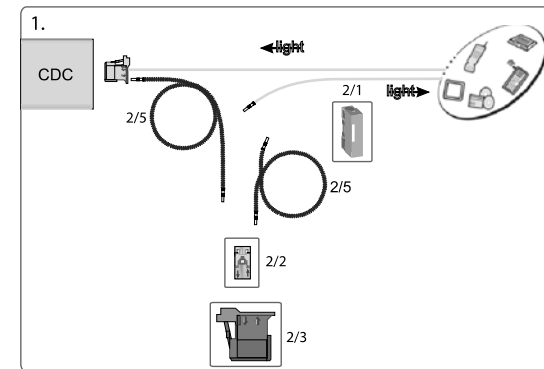

Electrical installation

Join each cable according to the numbers of the picture on the first page. Lead away the cables where the devices will be placed. (E.g the center console or in the glove compartment). Use the grommet when you are leading the cables through the plastic parts.

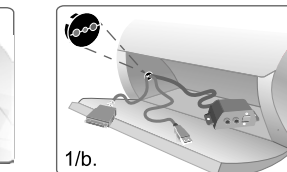
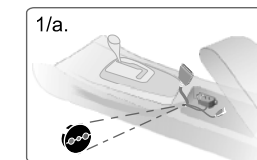

The AUX box and the clips from kit #3 and #4 can be assembled to a connector port, or you can use some of them separately (see figure #2).

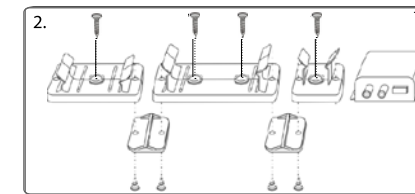

Text Configuration

To utilize the potential of your Gateway 500 best for Mercedes and Saab configuration is a necessary part of installation.

	Mercedes Audio 20/50	Mercedes Command	Porsche CDR	Porsche PCM	Saab Non Text	Saab Text
NO TEXT	+	+	0	-	+	-
Timeout	0	-	+	-	0	-
Text	-	-	-	-	-	-
+Cache	-	-	-	-	-	-
+Paging	-	0	-	+	-	0
+Select	-	-	-	0	-	+

+: Factory default, 0: Optional, -: Not possible

- 1. NO TEXT
- 2. +TIMEOUT
- 3. TEXT
- 4. +CACHE
- 5. +PAGING
- 6. +SELECT

After Gateway 500 was successfully installed and it is working, switch the mode selector switch six times (3 times on/off) rapidly and a configuration menu will appear on the display. Select the configuration mode according to the head unit type. Choose the wanted item for playing as it is written in the manual of your audio system. To confirm the selection, press ► on it. To discard the selection press ◀

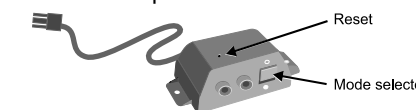

At service

When you have your car serviced you must set the mode selector switch to service mode/bypass, CD Changer/ position otherwise the service computer may detect an unknown device in the fibre optic system witch can lead to errors reported.

