



Parts and Accessories. Installation Instructions.

Headlight cleaning system retrofit BMW 5 Series (E60)

Retrofit kit No. 61 60 0 301 027

Installation time

The installation time is 3.5 hours, but this may vary depending on the condition of the car and the equipment in it.

Important information

These installation instructions are primarily designed for use within the BMW dealership organisation and by authorised BMW service companies.

In any event the target group for these installation instructions is specialist personnel trained on BMW cars with the appropriate specialist knowledge.

All work must be completed using the latest BMW repair manuals, circuit diagrams, servicing manuals and work instructions in a rational order using the prescribed tools (special tools) and observing current health and safety regulations.

Ensure that the cables/lines are not kinked or damaged as you install them in the car. The costs incurred as a result of this will not be reimbursed by BMW AG.

Additional cables/lines that you install must be secured with cable ties.

If the specified PIN chambers are occupied, bridges, double crimps or twin-lead terminals must be used.

Before you install the retrofit system, test the control module status with the CIP (coding, customising, programming) test program. If the test detects incorrect statuses in one or more control modules, these must be updated first using the "Load software" function.

All the figures show LHD cars, proceed in exactly the same way on RHD cars.

Pictograms



Denotes instructions that draw your attention to dangers.



Denotes instructions that draw your attention to special features.

◀ denotes the end of the instruction or other text.

See the EBA CD or Aftersales Portal for explanations of the pictograms.

Do not archive the hard copy of these installation instructions since daily updates are made by Aftersales Portal.

Subject to technical modifications.

Installation information

Some of the installation of the aerial is shown only on the left-hand side of the car, proceed in the same way on the right-hand side of the car.

After the installation work the retrofit kit must be programmed / coded using DISPlus or GT-1 via the **Retrofit** path.

Special tools required

None

Contents

Section	Page
1. Parts list	4
2. Preparations.....	5
3. Connection diagram.....	6
4. Installation and cabling diagram	7
5. To install the headlight cleaning system.....	8
6. To install and connect the wiring harness.....	11
7. Concluding work and coding	13
8. Circuit diagram	14

1. Parts list

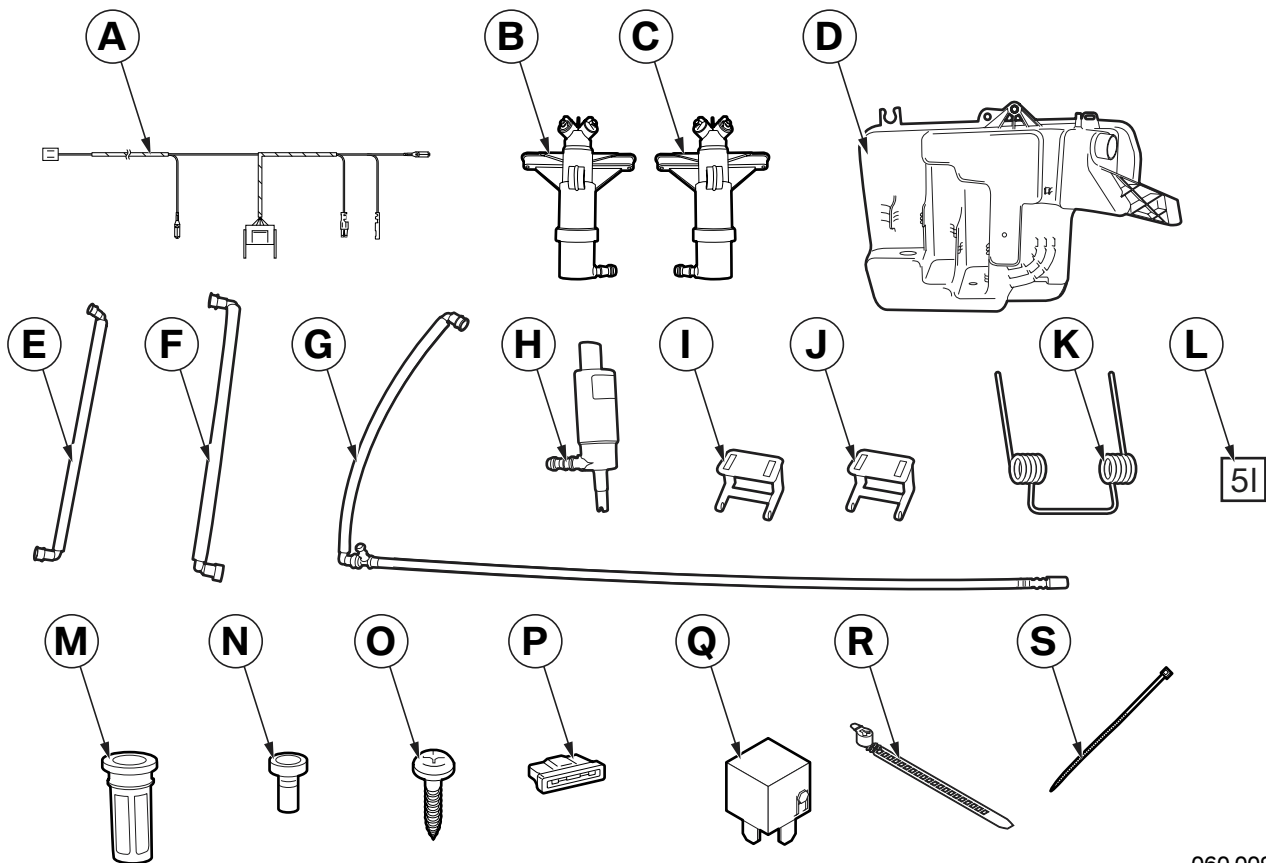

060 0093 Z

Legend

- A Wiring harness
- B High-pressure jet left
- C High-pressure jet right
- D Water tank
- E Hose line, right
- F Hose line, water tank
- G Hose line, left
- H Washer pump
- I Jet seal lever, left
- J Jet seal lever, right
- K Jet seal spring (2x)
- L Sticker 5 l
- M Screen
- N Screen
- O Fillister head screw (6x)
- P Fusible insert
- Q Relay
- R Cable tie (2x)
- S Cable tie (10x)

2. Preparations

	TIS No.
Conduct a brief test	---
Disconnect the negative pole of the battery	12 00 ...
The following components must be removed first of all	
Front bumper trim	51 11 156
Left headlight	63 12 010
Water tank for the windscreen washer system	61 71 061
Left microfilter	64 31 010
Glove box with casing	51 16 366
Trim at the bottom right of the instrument panel	51 45 181
Footwell trim at the bottom right	---
Fuse holder, glove box	---

3. Connection diagram

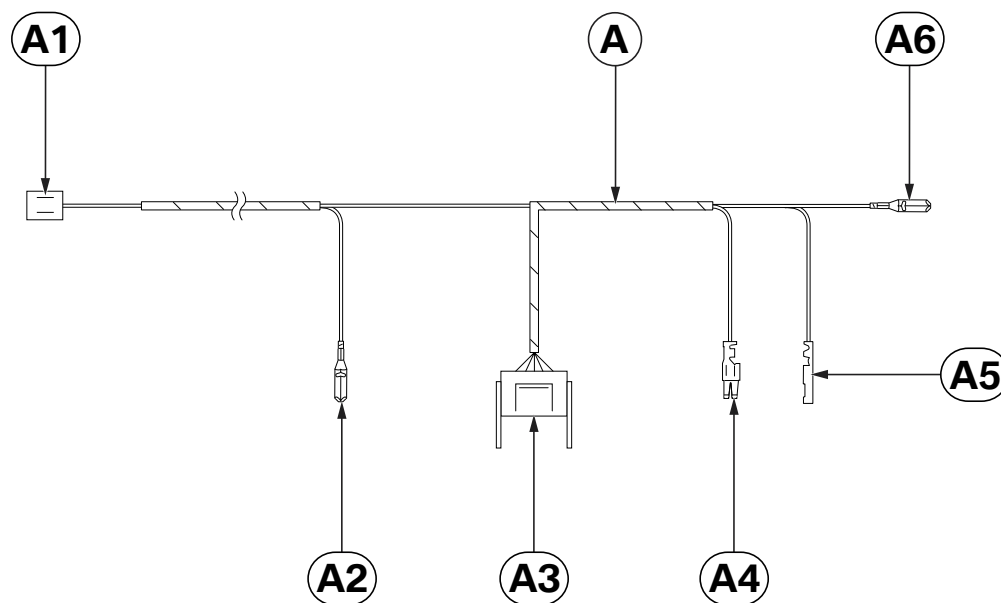

060 0094 Z

Item	Description	Signal	Cable colour / Cross-section	Connection location in the car	Abbreviation / Slot
A	Wiring harness	---	---	---	---
A1	2-pin socket casing, GR	---	---	To SRA washer pump	X1011
A2	Joint connector contact	Terminal 31	BR 2.5 mm ²	To joint connector above the fuse holder on the A pillar, bottom left	X13783
A3	Relay socket SW	---	---	Relay socket on the glove box fuse holder	X61
A4	Blade terminal contact	Terminal 30	RT/SW 2.5 mm ²	To grey 8-pin plug on the fuse holder on the glove box	X11004 PIN 1
A5	Socket contact	SRA	BL/SW 0.35 mm ²	To black 54-pin plug on the base module	X13252 PIN 1
A6	Joint connector contact	Terminal 31	BR 0.35 mm ²	To joint connector above the fuse holder on the A pillar, right	X13782

4. Installation and cabling diagram

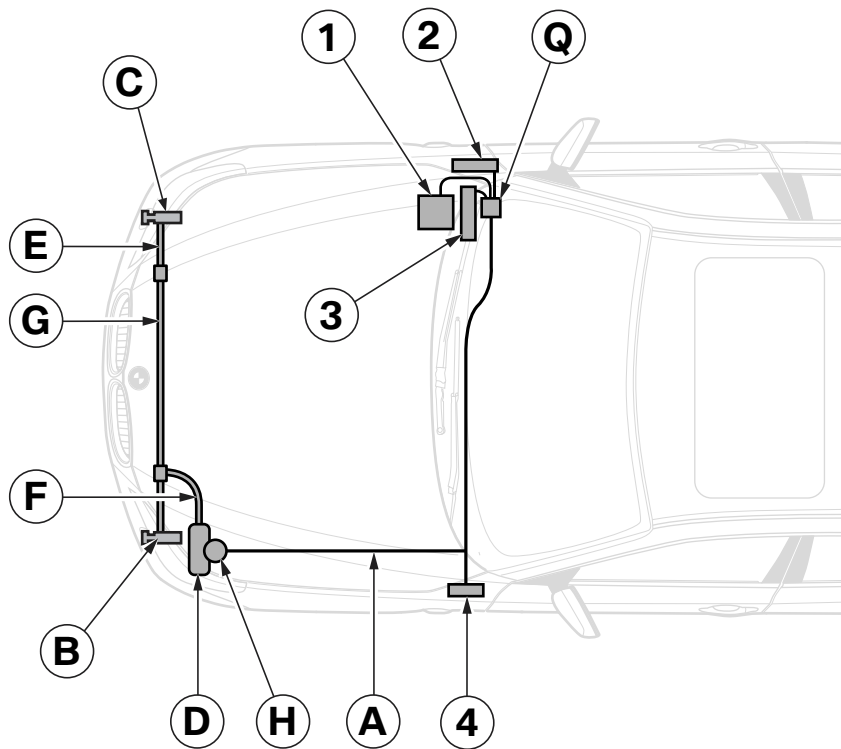

060 0095 Z

Legend

- A Wiring harness
 - B High-pressure jet left
 - C High-pressure jet right
 - D Water tank
 - E Hose line, right
 - F Hose line, water tank
 - G Hose line, left
 - H Washer pump
 - Q Relay
-
- 1 Base module **A1**
 - 2 Joint connector **X13782**
 - 3 Fuse holder **A41**,
 - 4 Joint connector **X13783**

5. To install the headlight cleaning system

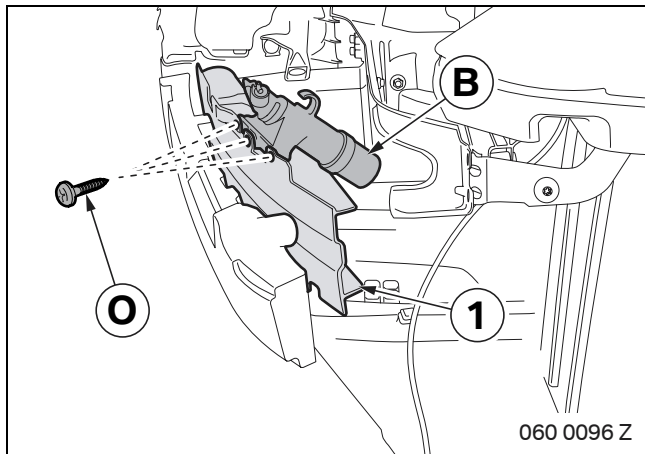

Secure the high-pressure jet on the left **B** to the bumper (1) using fillister head screws **O**.

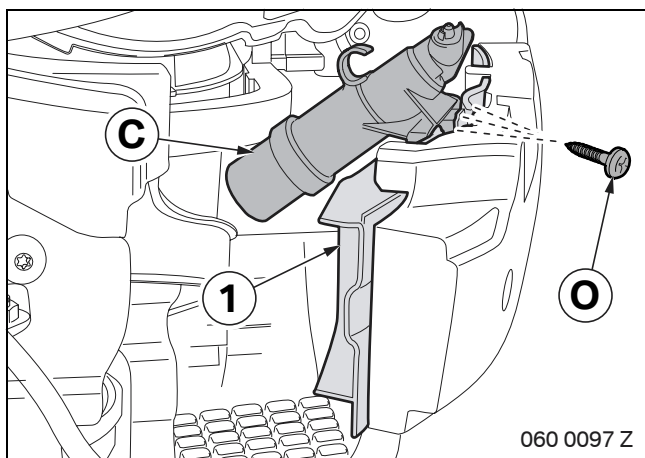

Secure the high-pressure jet on the right **C** to the bumper (1) using fillister head screws **O**.

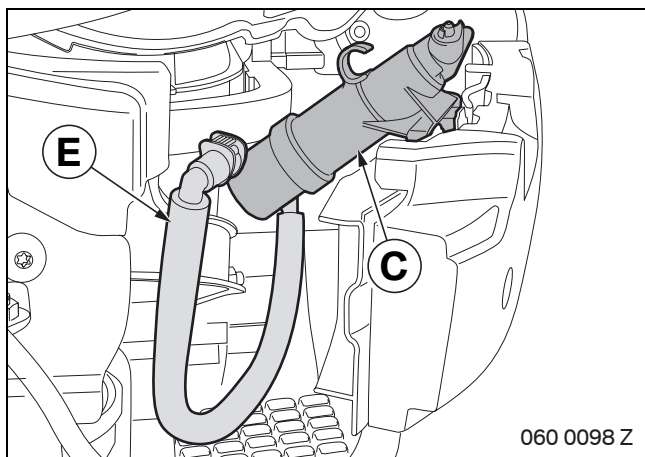

 Do not fit the fastening bar on the plug connector for the high pressure lines until they have been connected to prevent them rising. ◀

Connect the hose line on the right **E** to the high-pressure jet on the right **C**.

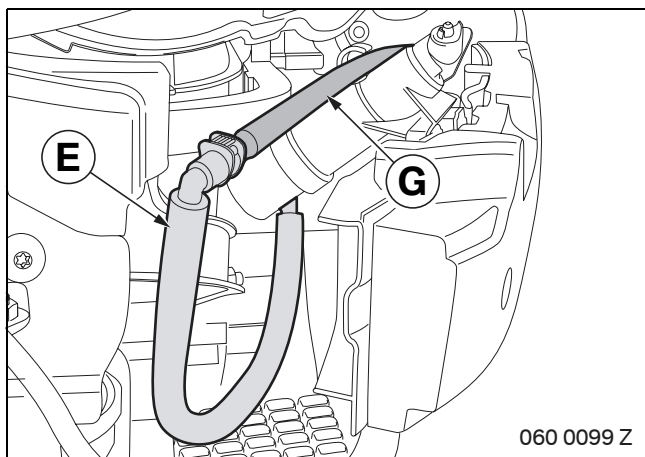

Thread the left-hand hose line **G** from the right to the left side of the car through the bumper section and connect it to the right-hand hose line **E**.

5. To install the headlight cleaning system

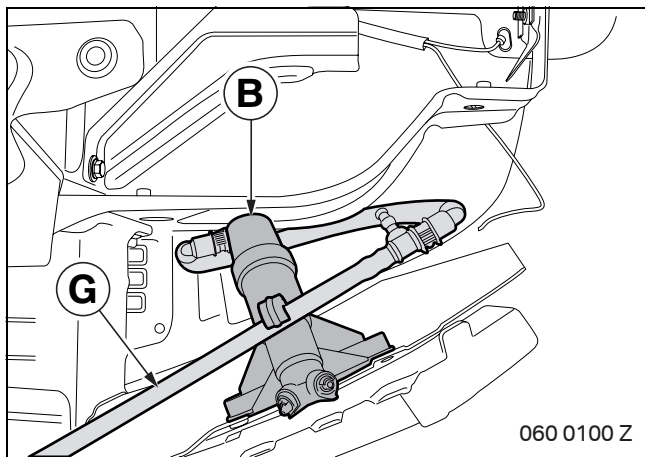

Connect the left end of the left-hand hose line **G** to the high-pressure jet on the left **B**.

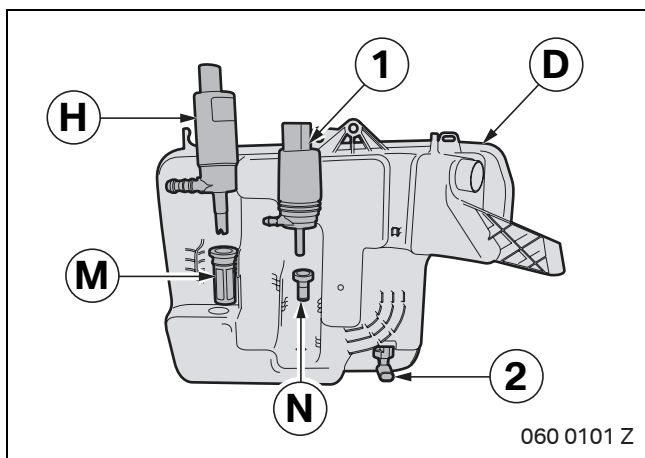

Fit the following parts on the water tank **D**:

- Windscreen washer pump (1) with new screen **N**
- Washer pump **H** with screen **M**
- Check that the level switch (2) is correctly positioned.

Connect the hose line for the windscreen washer system to the windscreen washer pump (1)

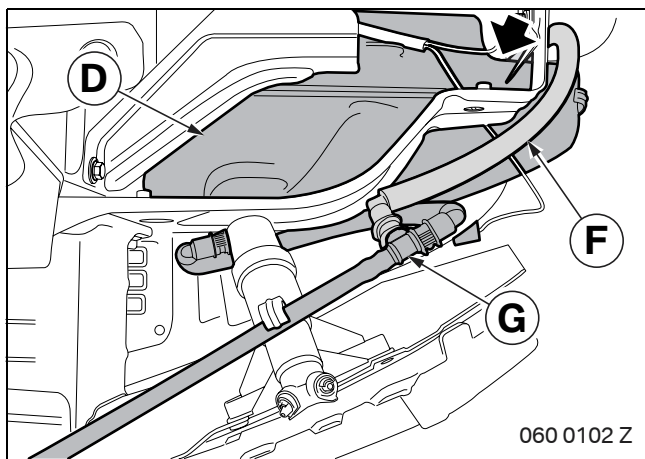

Connect the water tank hose line **F** to the branch of the left-hand hose line **G** and then connect it to the washer pump **H**.

Connect the plug to the level switch and the windscreen washer pump.

Connect the filler and bleed hose to the water tank **D**.

Check that all connections and sealing rings are secure, secure the water tank **D** to the car.

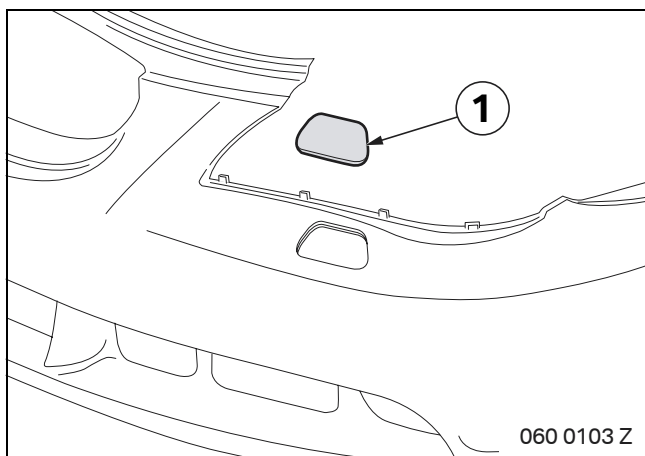

Unclip the painted cover for the high-pressure jet (1) from the inside of the bumper trim on the left.

5. To install the headlight cleaning system

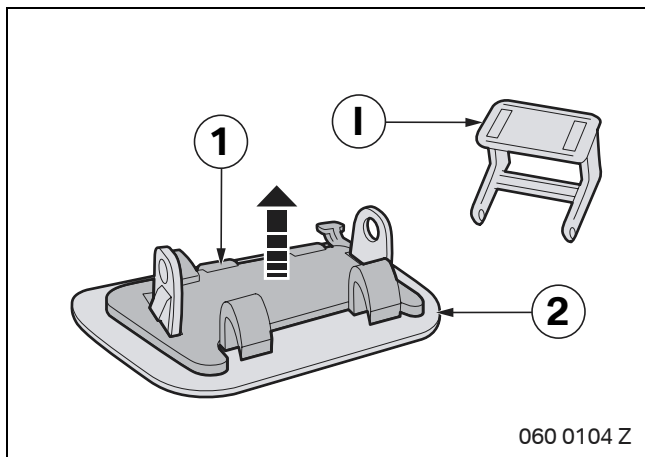

Undo the catch mechanism, take the cover (1) off the support (2) and fit the jet seal lever in its place I.

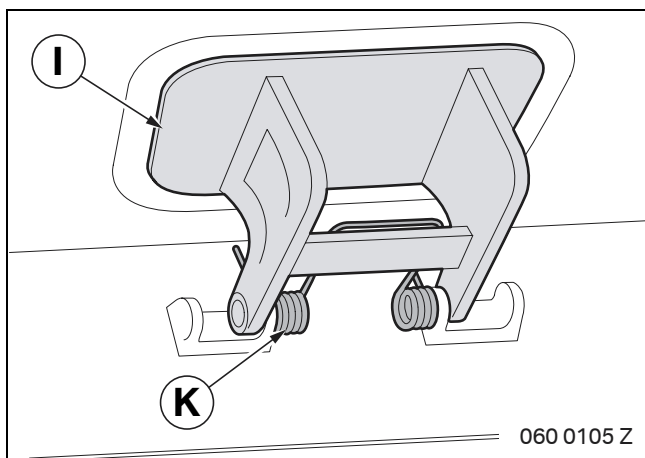

Fit the cover with the jet seal lever I into the bumper trim and secure it with the spring K so that the cover is closed by the spring force.

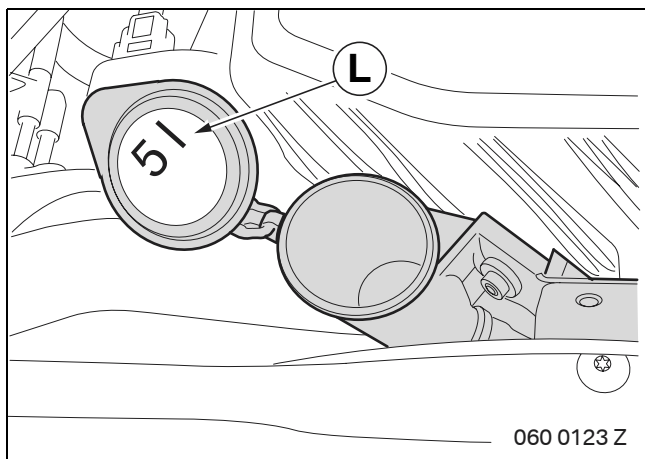

Affix the sticker L, Capacity 5 l, on to the inside of the water tank cover.

6. To install and connect the wiring harness

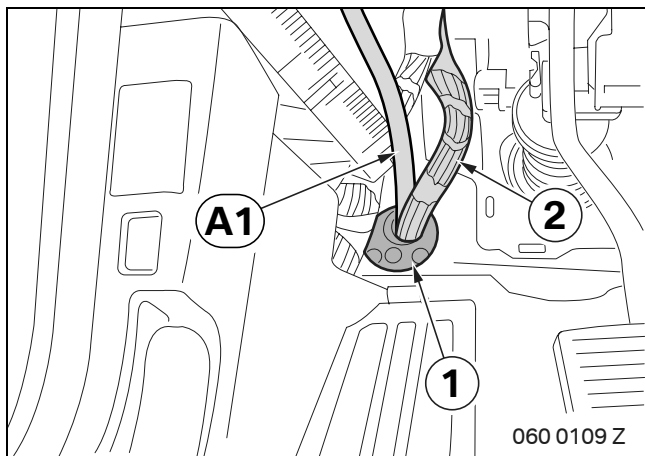

Route branch **A1** on the wiring harness from the glove box under the instrument panel, along the standard wiring harness and to the footwell on the driver's side.

Thread branch **A1** through the grommet (1) into the engine compartment and from there along the existing wiring harness (1) to the washer pump.

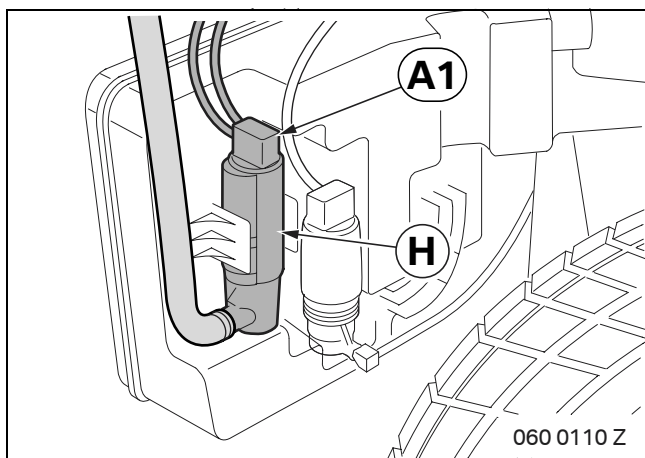

Connect the BR cable to PIN 1 of the 2-pin socket casing **A1**.

Connect the SW/BR cable to PIN 2 of the 2-pin socket casing **A1**.

Place the socket casing **A1** on the washer pump **H**.

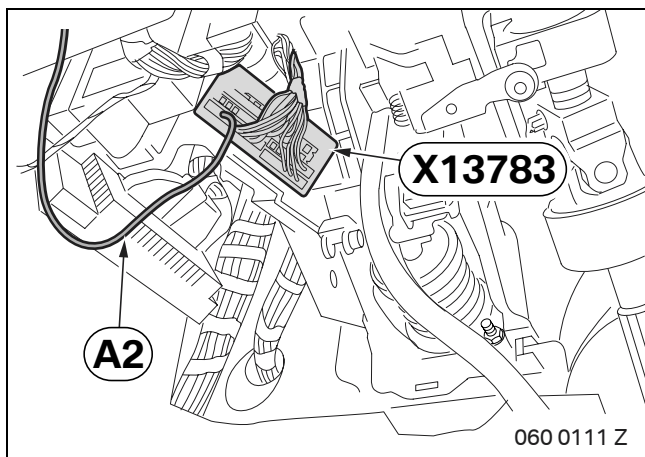

Connect branch **A2**, BR to the earth joint connector **X13783** above the fuse holder on the left-hand A pillar.

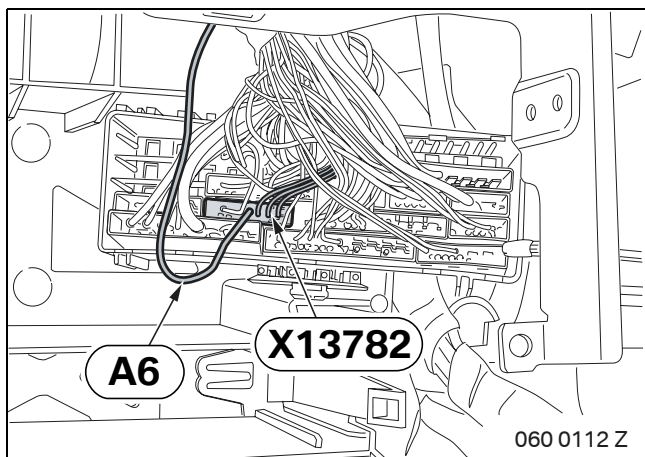

Connect branch **A6**, BR to the earth joint connector **X13782** above the fuse holder on the right-hand A pillar.

6. To install and connect the wiring harness

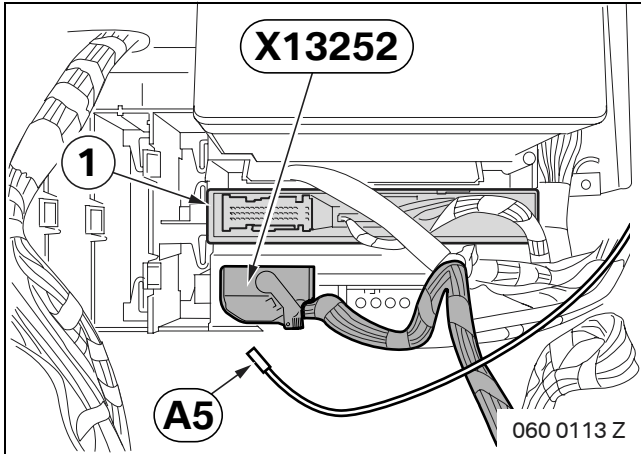

Connect branch **A5**, BL/SW, to PIN 1 of the 54-pin plug **X13252** of the base module (1).

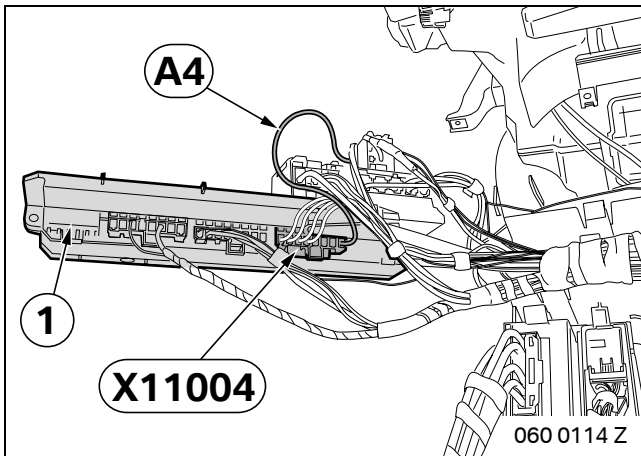

Connect branch **A4**, RT/SW, to PIN 1 of the 8-pin plug **X11004** on the fuse holder (1).

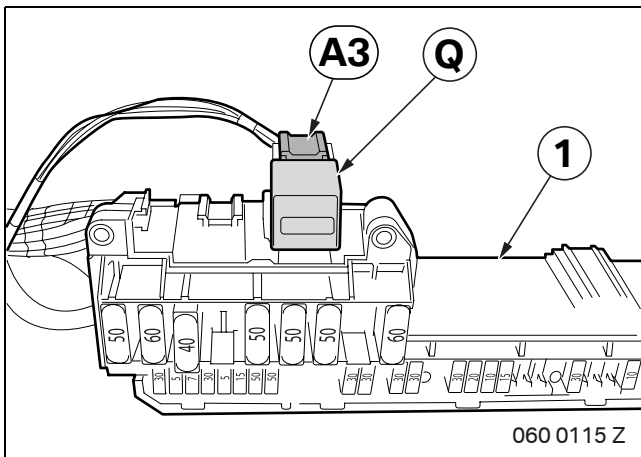

Connect branch **A3**, relay socket to the relay **Q** and secure it to the top of the fuse holder (1).

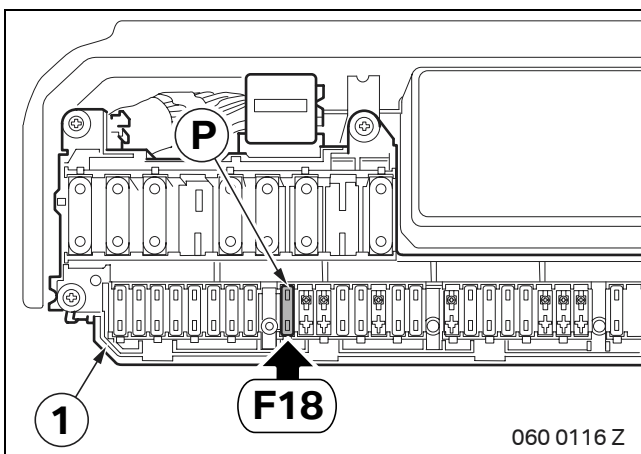

Secure the fuse holder (1) and insert the fusible insert **P** into slot F 18 of the fuse holder.

7. Concluding work and coding

This retrofit system requires coding.

- Connect the battery
- Code the retrofit using DISPlus or GT-1 via path **Retrofit**
- Conduct a brief test
- Conduct a function test
- Re-assemble the car

8. Circuit diagram

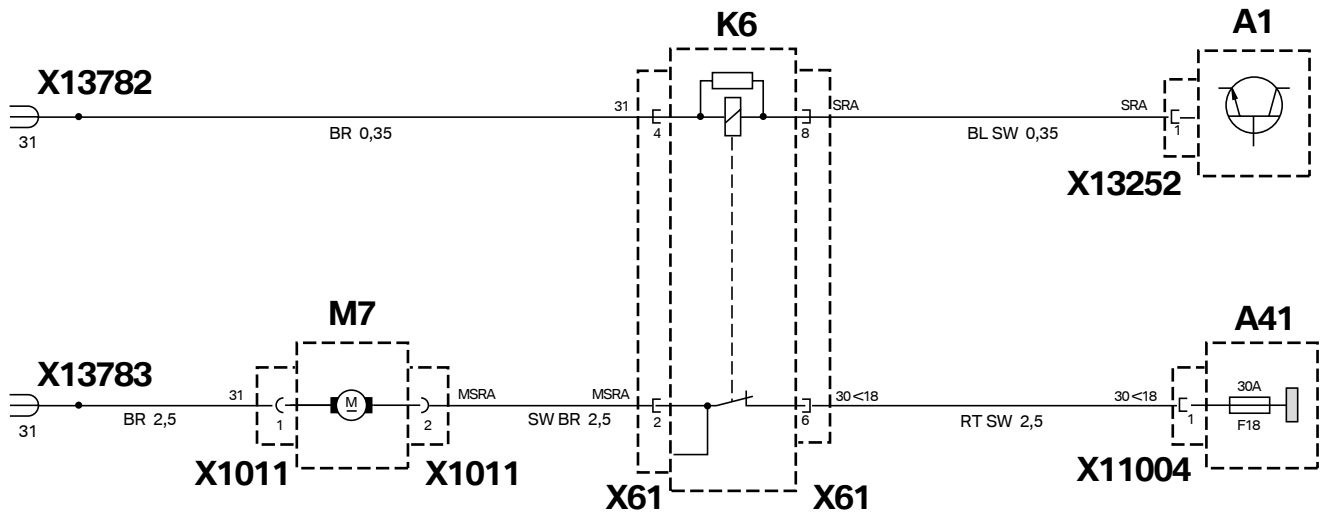

060 0117 Z

Legend

A1	Base module
A41	Fuse holder, glove box
K6	Relay
M7	SRA washer pump
X61	Relay socket
X1011	2-pin plug on washer pump
X11004	8-pin plug on fuse holder
X13252	SW 54-pin plug on base module
X13782	Terminal 31 joint connector, right-hand A pillar
X13783	Terminal 31 joint connector, left-hand A pillar

Cable colours

BL	Blue
BR	Brown
GE	Yellow
GN	Green
GR	Grey
RT	Red
SW	Black
VI	Violet
WS	White