



# Installation Instructions

Group Description

Instruction  
Number

Product  
Development

## SUBJECT CPT 9000 TELEPHONE INSTALLATION

### MODEL- E 60 5 SERIES

### INSTALLATION TIME

The average installation time for this kit is approximately 1 hour.

These instructions were developed especially for BMW vehicles and are not to be compared to any existing instructions for vehicles other than BMW. No methods other than those specified in this document are to be used to install **CPT 9000 phone kit**

### PARTS INFORMATION

Description	Qty	BMW Part Number
Eject box	1	84 11 6 946 537
Eject box frame	1	51 16 7 060 175

### PROCEDURE:

This manual has been prepared by *BMW of NORTH AMERICA Inc.*, to provide BMW technicians with proper instructions for installing the Motorola V60 i cellular telephone into 5 Series (E60) vehicles.

These instructions were developed by *BMW of NORTH AMERICA, Inc.*, Product & Service Engineering Department, specifically for BMW vehicles and are not to be compared to any existing instructions for vehicles other than BMW. No methods other than those specified in this manual are to be used to install the cellular telephone.

The instructions in this manual were complete and up to date at the time of issue. Any changes in the vehicle, cellular telephone or problems noted by installation personnel should be reported to BMW Product & Service Engineering Department along with VIN, manufacture date and as much detail as possible

Carefully read all instructions and Supplements before proceeding with installation. Those instructions dealing with a stock part of the vehicle but not stated in detail, should be referenced with information in the TIS section of the DIS tester. Left and Right are determined from the driver's seat.

- Vehicle is factory fitted with a dual element antenna. A secondary antenna is not required.

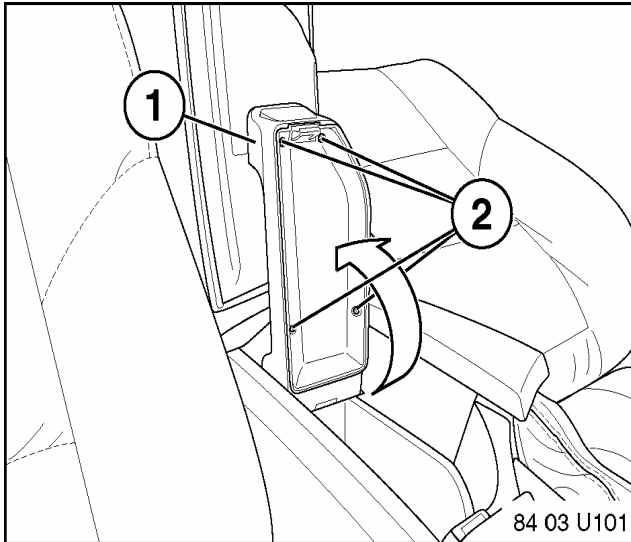

Reference illustration 84 03 U101

Raise center arm rest (1) to expose 4 T10 Torx head screws (2). Remove 4 screws and discard coin tray that was previously installed in production.

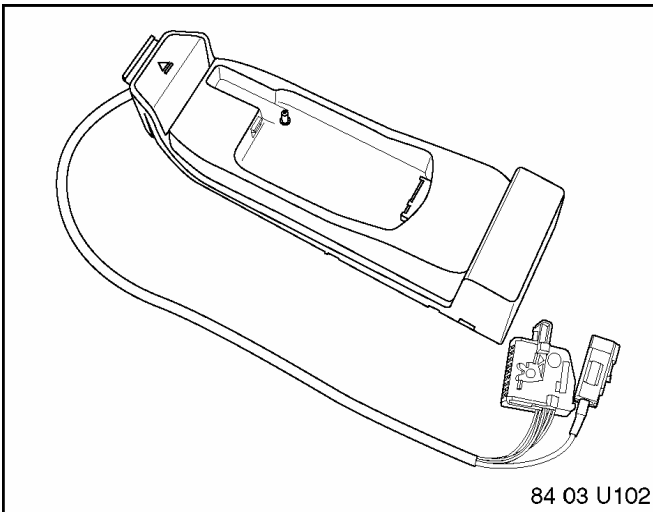

Reference illustration 84 03 U102

Eject box 84 11 6 935 892

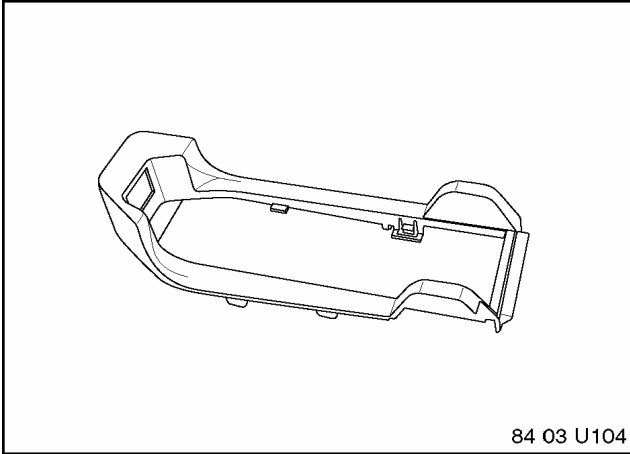

Reference Illustration 84 03 U104

Eject box bezel 51 16 7 160 175

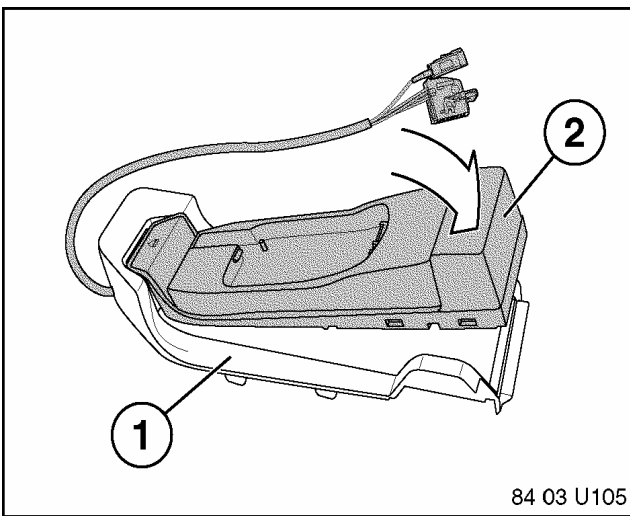

Reference illustration 84 03 U105

Install eject box (2) into bezel (1) making sure that the clips lock it in place .

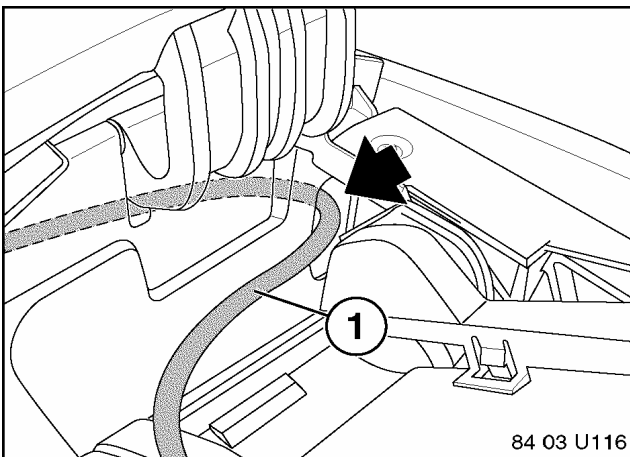

Reference illustration 84 03 U116

This shows the routing for eject box wiring.

Armrest and plastic trim on driver's side needs to be removed to route harness.

Route connector for eject box and antenna coax cable through cut out in center console. Make sure harness is not damaged as it gets pulled through from the rear side of the center console.

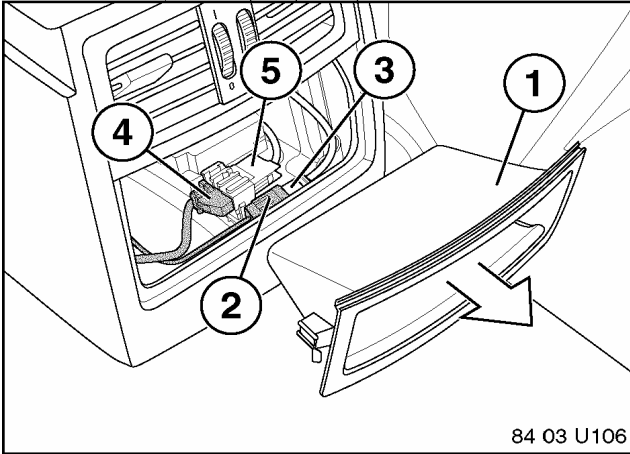

Reference illustration 84 03 U106  
 Remove tray (1) under rear center vent in console to gain access to the wire harness for eject box. Remove center vent assembly. Route Eject box harness through center console.

Connect eject box (4) to vehicle harness (5)

Connect antenna coax cable (2) to vehicle antenna coax cable (3). Reinstall tray (1).

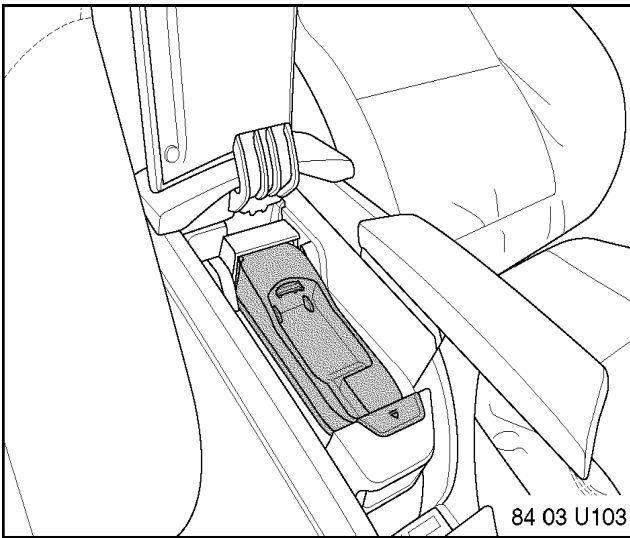

Reference Illustration 84 03 U103

Installed eject box and bezel assembly in center console.

Reinstall 4 T 10 torx screws that were previously removed from the under side to secure eject box in place

Reinstall plastic trim and drivers armrest pad.

NOTE: Make sure harness is not pinched and that the eject box can be pivoted with no resistance.

## Programming

After complete installation of eject box , TCU **requires** to be programmed via DIS Tester.

Because of roadside and emergency calls, the **full vehicle identification number** must be programmed into the TCU. Failure to program the number in will result in the emergency call center not being able to recognize the owner of the vehicle. Although the vehicles location will still be transmitted.